



12 Earle Street

, Ashton-Under-Lyne, OL7 0EL

Offers in the region of £140,000

YOUR PROPERTY CENTRE welcome to the market this mid-terraced property located on Earle Street in the town of Ashton-Under-Lyne. Its proximity to the town centre makes it convenient for all your shopping, dining, and entertainment needs, adding to the appeal and giving exceptional transportation network links. The property has recently been redecorated throughout in neutral décor ensuring move in ready condition.

On entry you are welcomed by a vestibule leading to a spacious lounge area then onto a sizeable kitchen / diner. To the first floor there are two bedrooms and a bathroom with 3 piece suite plus electric shower.

Additionally, the yard to the rear of the property provides a private outdoor space where you can enjoy some fresh air or perhaps create a beautiful garden oasis.

Whether you are looking for an investment opportunity or purchasing your first home, this property is ideal for both scenarios. The chain-free status ensures a smooth and hassle-free buying process, allowing you to move in or rent out without any delays.

- IDEAL INVESTMENT / FIRST TIME BUYER OPPORTUNITY
- CLOSE TO TRANSPORTATION LINKS
- NO CHAIN
- FREEHOLD
- REAR YARD
- COUNCIL TAX BAND A

Viewing

Please contact our Your Property Centre Office on 0161 343 2530 if you wish to arrange a viewing appointment for this property or require further information.



Floor Plan



Area Map



Energy Efficiency Graph

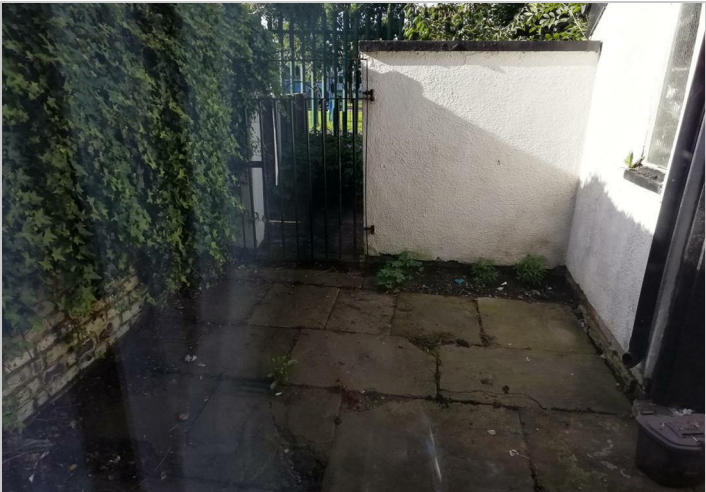
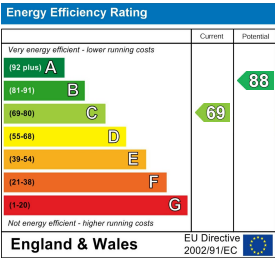

These particulars, whilst believed to be accurate are set out as a general outline only for guidance and do not constitute any part of an offer or contract. Intending purchasers should not rely on them as statements of representation of fact, but must satisfy themselves by inspection or otherwise as to their accuracy. No person in this firms employment has the authority to make or give any representation or warranty in respect of the property.